

# Murder She Rhymed



By 1928, Moose Jaw, Saskatchewan, a thriving city on the Canadian prairie, had earned its reputation as a “Little Chicago.”

Not only was it filled with vice and corruption, but it was also a place where “Scarface” Al Capone himself called the shots.

Written and developed by

**Jack Pachuta**

Management Strategies, Inc.

MSI Internet Sales

PO Box 191

Cedarburg, WI 53012

262/377-7230

jack@pachuta.com

www.mysteries-on-the-net.com

Copyright, 2012. All rights reserved.

## **How to Organize “Murder She Rhymed”**

Thanks for purchasing this murder mystery party kit. You and your guests will enjoy the challenge of solving a crime that will test everyone’s powers of deduction. The scenario is based on REAL-LIFE EVENTS that occurred in Moose Jaw, Saskatchewan in the 1920s. *Half of the roles in this mystery are based on people who actually lived in Moose Jaw in 1928.*

**Here is what you should do to coordinate your murder mystery evening:**

**STEP 1: Review the materials in this mystery packet.** But ... please do it in a very specific way. Remember - you have ALL of the information, *including the solution to the mystery*. If you decide to participate in the mystery as a role player or an investigator, you’ll want to keep yourself in the dark about WHO DONE IT.

All page numbers in this packet are subdued in the upper left-hand corner of the pages as you look at them vertically. That way you can run off the material without having the page numbers interfere with the format. The entire packet includes:

- **Instructions on how to organize the event.** They’re on pages 2 through 5. (You’re reading them right now.)
- **Instructions for “Two-Gun” Hart, the Prohibition Agent.** Information for the person who will take charge of the murder investigation is on pages 6 thru 8.
- **The Scenario.** On page 9, you’ll find an overview of the scenario and a list of the six Prime Suspects and the 24 minor roles.
- **Prime Suspect Brochures.** One of six Prime Suspects murdered Mary Kelly. The Prime Suspects have special brochures with additional information about the case on pages 10 thru 21. The brochures should be run off back to back as three-panel, two-fold documents. In addition to information about their roles, each Prime Suspect is assigned a “prop” to bring to the mystery evening that could be a murder weapon. The six Prime Suspects are:
  - 1.) Mamie
  - 2.) Jake
  - 3.) Roxie Rosen
  - 4.) Chief Wilson
  - 5.) Lily Lu
  - 6.) Mayor Dunhill
- **Role Cards.** The 24 role cards for the rest of your guests are on pages 22 thru 37. They are designed to be run off back to back, three roles per page. Trim them correctly so that the same name is on the front and back of each card. You might want to use heavier card stock.
- **The Invitations to the Party.** The invitations on pages 39 thru 42 will be sent to each guest. Follow the instructions on page 38 to prepare them.
- **Limericks.** You’ll find 15 limericks by Mary Kelly, the murder victim, on pages 44 through 47. Cut them out. Follow the instructions on page 43 to find out how to use them.
- **Agent’s Memo.** A memo from U.S. Prohibition Agent Richard Hart is one page 48. A copy of this memo will be attached to *The Moose Jaw Times Herald* and handed out by Hart to your guests as they arrive.
- **The October 24, 1928 Edition of *The Moose Jaw Times Herald*.** Everyone will receive a copy of the newspaper on pages 49 and 50 when they arrive at the investigation. Run the pages off back to back.
- **Confidential File.** The RCMP file on page 51 will be distributed to each team after the suspects give their accounts of the crime. Run off one copy per team. If you like, you can put them in manila folders for distribution.

- **Diagram.** The diagram of “The Boss’s” office and Mamie’s Saloon on page 52 will be handed out by Hart before the questioning begins. Run off a copy for each team.
- **Agent’s Notes.** The Agent’s Notes on page 53 will be distributed after the fourth round of questioning. Run off one copy per team.
- **The Answer Sheet.** Run off one answer sheet on page 54 for each investigative team.
- **The Denouement.** *This is the solution to the crime.* Run off pages 55 through 59. Hart will read these pages at the end of the evening.
- **Limerick Meanings.** Some of your guests will want to know the significance of the limericks written by Kelly. Pages 60 and 61 briefly indicate what the rhymes mean. You can *either answer questions about the limericks after the event is over, or post the pages in a central location so that everyone can see them.*

**STEP 2: Plan your event.** Pick a date on which to conduct the murder mystery event. *Murder She Rhymed* is designed to be an evening’s entertainment. **Remember: this mystery is for serious sleuths. It will take two to two-and-a-half hours to solve the case using the recommended format.** Because of this, a buffet meal is recommended for the mystery evening. If you have a sit-down meal, add the amount of time the meal will take to your planning time.

**STEP 3: Select your role players.** Review the scenario and the brief descriptions of roles on page 9. Select guests who will fit into these roles. The six Prime Suspects are key to the investigation. Make sure you assign those roles to individuals who will definitely be at your party. The minor roles should be assigned to your other guests.

Everyone should bring the information with them and use it as a reference when they are circulating among the other guests. (*Consider running off extra roles for each guest. Some of them will forget to bring their roles to the party.*)

**STEP 4: Invite your guests.** Approximately three to four weeks in advance of the event, send invitations to the party to your guests along with their roles.

- If you have *fewer guests than the 30 roles* included in the mystery, you can selectively eliminate the six roles that have a small moose at the top of their role cards. These are minor roles that won’t affect the outcome of the case.
- If you have *more guests than the 30 roles*, simply assign the extra guests to one of the six investigative teams. They will work with their team members to help solve the case. *Be sure to send the proper invitation to the non-role players.*

**The mystery takes place at Mamie’s Saloon, a popular establishment in Moose Jaw where “The Boss” maintains his office. Here’s what to do on the night of the mystery event.**

**STEP 5: Select a person to play the role of “Two-Gun” Hart.** Since he will be facilitating the investigation, he should read the *Instructions* on pages 6 thru 8, and review the information in the packet to keep the event moving so that the investigation is conducted effectively.

**STEP 6: “Two-Gun” Hart greets the guests.** He gives each guest his *Agent’s Memo with a copy of The Moose Jaw Times Herald*. **Mary Kelly was murdered before your guests arrive.**

4

He tells your guests to mingle and talk with each other to find out more about who everyone else. Guests can, at their discretion, share or withhold any information in their roles. If you like, you can make nametags for your guests with their character names.

**STEP 7: Begin the Investigation.** Hart gathers everyone in a central location:

- Hart introduces himself as a U. S. Prohibition Agent who's been asked by Canadian authorities and the RCMP to assist in the investigation of bootleg liquor being shipped to the United States via the Canadian National Railroad.
- He reminds everyone that Mary Kelly died earlier in the day. Her body was found in an office in Mamie's Saloon, believed to be the local headquarters of Al Capone.
- He then informs everyone that Mary Kelly was a lyricist who composed limericks that she recited, then hid throughout Moose Jaw.
- Hart asks the *six Prime Suspects* to speak in the order indicated on the top of page 5 of their roles. They stand and read their "Accounts of the Crime." The sequence is:
  - 1.) Mamie, 2.) Jake, 3.) Roxie Rosen, 4.) Chief Wilson, 5.) Lily Lu, 6.) Mayor Dunhill

**STEP 8: The investigation begins.** When the Prime Suspects are finished, Hart reviews what happened, including such facts as:

- Some people thought Mary Kelly "knew too much" and was considered a threat by certain citizens of Moose Jaw.
- Only *one* of the Prime Suspects committed the murder.
- MOTIVE, MEANS and OPPORTUNITY must be considered to solve the case.

**STEP 9: Form investigative teams.** Have the guests form **six** investigative teams. Team members will work together to solve the case. **Do not include the Prime Suspects in the teams.** They will be circulating among the teams to answer questions about the murder. If you have more than 30 guests, your teams will consist of people who have been assigned minor roles and those who have no assigned roles.

**STEP 10: Distribute the Confidential File.** Give each team a copy of the Royal Canadian Mounted Police file about Al Capone.

**STEP 11: Break for dinner or refreshments.** The teams may continue to question each other to obtain as much information as possible while they are eating, *but they cannot question the Prime Suspects yet.* You might want to have the Prime Suspects eat in a separate table.

**STEP 12: Continue the investigation.** At the end of the meal, tell the teams that it is time to start the investigation again. Hart says he drew a diagram of the area and gives each team a copy of page 52. Each team should then find an area to use as an interrogation room.

**STEP 13: Coordinate the questioning.** Have one Prime Suspect rotate to each interrogation room at four-to-six-minute intervals. Investigators may ask the Prime Suspects ANYTHING.

The Prime Suspects should use the information provided in the *Prime Suspect Brochures* to answer the questions. Prime Suspects should *not* withhold any bits of information, but they should not offer information unless the investigators specifically ask for it. Good investigators

must ask the right questions to get the correct information. Each team questions each Prime Suspect *one time*. The questioning should last a total of time of 25 to 40 minutes.

**STEP 14: Distribute The Agent's Notes.** After the fourth suspect is questioned by each team, Hart loudly announces that he has been taking a few notes about the case. He can either read the notes from page 53 out loud or distribute a copy to each team. (Consider doing both.)

**STEP 15: Conduct open questioning.** Place the Prime Suspects in different parts of the facility. For a five-to-seven-minute period, investigators from any team may go to the suspects and ask final questions. *WARNING: Some investigators will try to pull the suspects back to their teams. Don't permit this.* Several different teams may question a Prime Suspect at the same time.

**STEP 16: Distribute Answer Sheets.** Pass out the Answer Sheets on page 54. Give teams 10 to 12 minutes to write out their solutions by responding to the items on the *Answer Sheet*.

**DISCRETIONARY STEP:** If you want the event to close on a “theatrical” note, Hart takes the Prime Suspects to a location where the other guests cannot hear what’s going on. He briefly reviews the scenario and (if he knows it) gives the solution of the case to the Prime Suspects. Hart tells them that, when they enter the room where all of the teams are gathered, they should line up and react “in character” if they are accused of being the murderer.

The guilty party *should not* reveal that he or she is the murderer until the denouement of the case is read. Instead, all of the Prime Suspects should react with exaggerated denials and gestures and accuse each other of the crime.

**STEP 17: Teams give their solutions.** Teams gather in a central location and Hart asks the questions on the answer sheet to each team, one at a time. A spokesperson for each team reads the answers exactly as they were written on the answer sheet. *NOTE: Often, a team will want to change its mind after hearing the answers from another team. Don't let this happen.*

**STEP 18: Read “The Denouement.”** Hart opens the envelope in which “The Denouement” was placed. He reads it aloud to the guests. This will take 6 to 8 minutes. You can (at your discretion), shorten the denouement. *Be careful when doing this. The Denouement logically explains what happened and how to identify the guilty party. If you edit it too much, the solution might not make sense.*

**STEP 19: Award prizes.** You may want to award prizes to the investigative team that did the best job of solving the crime. Let your creativity run wild in selecting the prizes.

**It's business as usual!**

I hope this little incident doesn't spoil your pleasure here tonight. At Mamie's Saloon, you'll always have a good time. Prohibition might be the law in the States, but here, you can drink legally, and often.

Sometimes, my patrons have a little too much - like Mary Kelly. Since the Chief fired her, she's been in here, sponging drinks off my regulars and reciting those limericks that she leaves all over town.

When "The Boss" called the meeting, I figured something was going to happen. I was standing in front of his desk, Kelly was on my left, and Jake was standing guard at the door. "The Boss" called Roxie in, and she stood behind him. Oh yeah, someone had dropped a pair of scissors on the floor. I could see them under the desk.

The lights have been going on and off all day here in the saloon, so I wasn't surprised that they went off again when we were in the office. The controls are in the tunnels right beneath our feet. It's probably some sort of wiring thing. I guess someone figured, since the lights were out, it would be a good time to take care of unfinished business with Kelly.

I'm sure it wasn't anything personal. It was just business. We do a lot of business here at Mamie's Saloon.

### Your PROP:

A long, thin cigarette holder.

When you gesture, wave the cigarette hold in the air with a great deal of flourish.

## Murder She Rhymed

Prime Suspect Role

# Mamie

Owner of Mamie's Saloon

You are portraying *Mamie*, the owner of *Mamie's Saloon* and a **Prime Suspect** in the murder of Mary Kelly, the former cook and housekeeper of Moose Jaw Chief of Police Wally Wilson.

As a Prime Suspect, you are one of six people whom Prohibition Agent Richard Hart will ask to speak and give their accounts of the crime. All six of you were present in "The Boss's" office when the lights went out and Mary Kelly was stabbed to death.

### Here's what to do:

- Prior to Hart asking you to speak, circulate among the other guests and, if asked, reveal any of the information on **pages 2 and 3** of this brochure.
- When Hart asks for *Your Account of the Crime*, read the dialogue on **page 5**.
- When questioned by the other guests **AFTER** you've given you account, reveal any of the information on **page 4** *if you are asked to do so*.
- **IMPORTANT:** Bring the PROP on **page 6** with you to the investigation.

**Any of the Prime Suspects (including you) could be the murderer!**

Copyright, 2012

**Mysteries on the Net**

Management Strategies, Inc.

PO Box 191

Cedarburg, WI 53012

www.mysteries-on-the-net.com

(262)377-7230

jack@mysteries-on-the-net.com

## Mamie

You, **Mamie (You don't use a last name)**, are the owner of *Mamie's Saloon* in Moose Jaw. You purchased the saloon eight years ago when you were 35 years old. It is located in the downtown section of the city above the tunnels that were built to house pipes and utilities.

For the past three years, you have provided office space to "Scarface" Al Capone who runs his Moose Jaw operations from your premises. Although you don't ask questions, it's common knowledge that Capone (referred to as "The Boss.") is procuring bootleg liquor from suppliers in the prairie and shipping it to Chicago on the railroad.

Capone pays you a substantial "rent," but you're getting tired of his demands. Plus, you've heard that the RCMP is secretly investigating the bootlegging and you don't need any trouble.

Added to this, one of your patrons, an Irish woman who drinks a bit too much named **Mary Kelly**, is threatening to tell the truth about what's happening in Moose Jaw. Since she used to work for Chief of Police **Wally Wilson**, you're concerned that she could point an incriminating finger at you.

Kelly writes limericks and is known to leave them around Moose Jaw. Some people think they contain clues about what's happening in town.

Capone's right-hand man, **Jake** (You don't know his last name), is constantly around when Capone is in town. Jake is loud and

obnoxious and acts like he's the one who's really in charge. He does whatever Capone orders and you don't trust him.

Before Capone set up offices at your saloon, you had a hard time making ends meet. Now, the saloon is always packed. Your piano player, **Doc**, has been with you since you opened the saloon. He is a star attraction as are singer **Daisy Dalton** and trombone player **Misty Mathison**. You hired Daisy six months ago when your previous vocalist, **Roxie Rosen** was hired by Capone to be his "personal assistant."

### Additional facts you should know:

**Doc** bangs the piano keys so hard that piano tuner **Harvey Jensen** pays regular visits to the saloon.

Capone regularly conducts "business" in his office and also takes care of his personal needs. It's not unusual to see doctor **Hugh Olds** or barber **Bill Beaman** exiting "The Boss's" office.

Moose Jaw has a large Chinese population because it helped construct the Canadian National Railroad through town. Many Moose Jaw citizens look down upon the Chinese and they've taken up residence in the tunnels beneath Main Street. You've heard that a "turf war" is underway between Capone and Head Chinawoman **Lily Lu**.

Capone's office has a secret escape passage that leads to the tunnels. He can come and go without being seen.

**Reveal this information only when you are questioned AFTER you've given your account of the murder!**

The meeting in "The Boss's" office was arranged this morning. Jake knocked on the door to your bedroom above the barroom. You were asleep. You went to the door and he told you that Capone needed to "straighten a few things out." He didn't say who else would be at the meeting. You went back to bed.

When you entered "The Boss's" office, you stood in front of his desk to **Kelly's** right. Head Chinawoman **Lily Lu** was standing to the left of Kelly, and **Chief Wilson** was behind her. **Roxie Rosen** was standing behind "The Boss" and **Jake** stood guard at the door. You don't know where **Mayor Dunhill** was.

The lights went out. You heard a scream. When they came back on, Kelly was lying in a pool of blood in front of the desk. Wilson told everyone except "The Boss" to leave the office. Jake stood guard outside the door as an ambulance took the body away.

You and **Roxie** went into the barroom and had a drink. That's when you realized that **Richard Hart** had arrived in the saloon. You're certain he wasn't there before all of you entered "The Boss's" office.

Electrical problems are a common occurrence in Moose Jaw, but today the it's been a bigger nuisance than it usually is. The master switch that controls the lights in the saloon, including "The Boss's" office, is behind the bar. You and Doc know where it is.

Your Role:  
**Harvey Jensen**  
Piano Tuner

**Information about you . . .**

You have been married to the former **Mabel O'Brien** for 27 years and have one daughter named **Bridgette** who now lives in Ontario. Mabel owns and operates *The Moose Jaw Haberdashery*, the finest hat shop in the province.

You have been tuning pianos in the Moose Jaw area for 25 years, and learned your trade from your high school music teacher, **Jacob Jones**.

Your professional tuning kit consists of muting felt, screwdrivers, tuning forks, piano wire, a tuning hammer, a tuning pin torque wrench, tuning levers, wedge mutes, and tuning tips. You carry it in a small black bag that some people say looks like a doctor's bag.

You're constantly upgrading your kit and recently received a shipment of new piano wire. You needed it because you use an inordinate amount of piano wire, especially tuning the piano at *Mamie's Saloon*. It almost seems as if it keeps disappearing before your eyes, but no one would want to steal piano wire. What could you do with it except tune a piano?

**Additional facts you should know:**

One of your regular customers is *Mamie's Saloon*. **Doc**, the piano player, bangs on the keys so hard that the instrument seems to constantly need tuning. You don't know why he's called "Doc." So far as you know, he's never had any medical training.

Your Role:  
**Mabel Jensen**  
Owner of *The Moose Jaw Haberdashery*

**Information about you . . .**

You are the former Mabel O'Brien and have been married to **Harvey Jensen** for 27 years. You have one daughter named **Bridgette** who now lives in Ontario. Harvey is a piano tuner who learned his trade from his high school music teacher, **Jacob Jones**.

Hat styles constantly change, but you brag that your shop is the only one in all of Saskatchewan that keeps up with the latest styles from Chicago. Your clientele consists of Moose Jaw residents and a group of people that have a "south of the border" Midwestern accent. You frequently hear them talking about "The Boss." You've heard from one source that he's really **Al Capone**.

**Additional facts you should know:**

Harvey is constantly ordering new supplies for his piano tuning kit. Recently, a large shipment of piano wire arrived at your house. Harvey said he needed it because he seems to use an inordinate amount of it, especially tuning the piano at *Mamie's Saloon*. Harvey told you that the piano player there, **Doc**, bangs on the keys so hard that the instrument constantly needs tuning.

Two weeks ago, your haberdashery was burglarized and some new ladies' hats that had just arrived were stolen. You reported the burglary to the Police Department, hoping to find the scofflaws. No one was ever arrested, but last week you saw a woman walking down the street wearing one of the hats. You reported it to Chief of Police **Wally Wilson** personally. He told you that you must be mistaken.

Your Role:  
**Harry Hill**  
Bagman for "The Boss"

**Information about you . . .**

You are 45 years old and have never been married. Your entire life, you've been involved in illegal activities. You find a certain excitement in being able to outwit the authorities.

In Moose Jaw, it's easy to be on the wrong side of the law because the Chief of Police, **Wally Wilson**, is on the take from "The Boss." He constantly looks the other way as bootlegging, gambling, drugs and prostitution thrive in the city. You know for a fact that some of his police officers are involved in burglarizing homes and businesses.

Your Model T Ford has been modified by mechanic **Butch Barret** because you frequently go on errands for "The Boss," even into the United States. Instead of one gas tank, you have two. One holds enough gasoline to make the long trek to Nebraska without refilling. The other tank holds bootleg alcohol. Last week you had a leak in one of the tanks and took it to Barret to be repaired.

When you get to Nebraska, your contacts there siphon out the alcohol and you return to Moose Jaw with an envelope that you hand over to "The Boss's" personal assistant, **Roxie Rosen**, a former singer at *Mamie's Saloon*.

**Additional facts you should know:**

During your last visit to Nebraska, you were confronted by an American Prohibition Enforcement Officer named **Richard "Two Gun" Hart**. He said he was on to you and not to be surprised if you saw him again, even in Canada.



## Harry Hill

You asked permission from "The Boss" to "rub him out" but were told "no." You don't understand why "The Boss" won't let you do something that needs to be done if you're to continue making your trips to Nebraska.

Lately, you've been gambling away some of the money that you collect for "The Boss" in Nebraska. You tell Roxie that your "contact" is a little short of cash, but you're keeping track of it.

During one card game in Nebraska, you played against someone named "**Aces**" **Art Dugan**. He took you for a lot of money. You want to find him to see if you can get some of your cash back. You're certain he cheated.

Dugan even noticed that your car had been modified. You told him to, "Forget about it."

You know that if "The Boss" ever found out you were gambling away his money, you'd be in big trouble. You're used to handling "situations" for him, including "making people disappear." Maybe you could do him a favor.

## Mabel Jensen

The woman wearing the hat was **Mona Olsen**, the wife of one of his sergeants, **Fred Olsen**. Wilson said that Fred Olsen had purchased the hat in Saskatoon and given it to his wife as a birthday present. You're certain that it was one of the stolen hats, but what could you do?

Recently, a big shipment of piano wire arrived at your house. Harvey said he needed it because he seems to use an inordinate amount of it, especially tuning the piano at *Mamie's Saloon*. The piano player, **Doc**, bangs on the keys so hard that the piano seems to constantly need tuning. Harvey was at Mamie's earlier today, tuning Doc's piano again.

You are a close friend of **Ethel Beaman**, the wife of barber **Bill Beaman**. Like you, Ethel is concerned about the crime in Moose Jaw. The two of you have secretly contacted the Royal Canadian Mounted Police to see if they can take over law enforcement from the local corrupt police force. Both of you have hopes that this could actually happen.

Because of this, you've developed a lukewarm friendship with **Mary Kelly**, a native of Ireland who settled in Moose Jaw. Until last month, she'd made a living as a housekeeper and cook for Chief of Police **Wally Wilson**. After a few drinks, Kelly's lips loosen up and she tells you about some of the things she overheard at the Chief's. Wilson fired her last month and she's now roaming the streets trying to find a way to earn a living.

Kelly writes limericks and she has told both of you to listen closely to what she writes because her rhymes are based on real facts. She's confided in you that she fears for her life because she "knows too much." She's told you and Ethel that she's even found a secret way to get into the tunnels beneath Moose Jaw.

## Harvey Jensen

Today, you were called to Mamie's to once again tune Doc's piano. You had to replace a significant amount of the piano wire. On the way out, you tossed the old piano wire into a trash can near the door. You noticed that the trash also contained clippings of dark hair.

Mabel has developed quite a friendship with **Ethel Beaman**, the wife of barber **Bill Beaman**. They are always together talking about what's happening in Moose Jaw. You try to stay out of it.

Lately, you've seen them with a woman who has an Irish accent. You're sure you've seen that same woman in *Mamie's Saloon*, getting loud and rowdy after a few drinks. You think the woman used to work for Chief of Police **Wally Wilson**.

The Chief has a reputation for "looking the other way" at crime in Moose Jaw, especially if he's well compensated for doing so.

**Invitation for guests who DO NOT have roles.  
Run this page off back to back with the next page.**



**Murder She Rhymed**  
Written and Developed by Jack Pachuta

**Mysteries on the Net**  
PO Box 191, Cedarburg, WI 53012, [www.mysteries-on-the-net.com](http://www.mysteries-on-the-net.com)  
(262)377-7230, [jack@mysteries-on-the-net.com](mailto:jack@mysteries-on-the-net.com)

# Murder She Rhymed



By 1928, Moose Jaw, Saskatchewan, a thriving city on the Canadian prairie, had earned its reputation as a "Little Chicago." Not only was it filled with vice and corruption, but it was also a place where "Scarface" Al Capone himself called the shots. AND . . . murder was as common a commodity as bootleg liquor.

**You are invited to a night filled with intrigue and mayhem.  
ARRIVE DRESSED FOR A 1928 PARTY!**

**MURDER MYSTERY PARTY**



**Join us for an unforgettable night in Moose Jaw!**

**Date and Time:**

**Location:**

**RSVP:**

### **Does she know too much?**

As Chief of Police Wally Wilson's cook and housekeeper, **Mary Kelly** eavesdropped on conversations that could embarrass some very important people in Moose Jaw. When her employment was abruptly terminated last month, she began roaming the streets of the city, writing limericks and seeking work.

If loose lips sink ships, then Kelly's boat may have sprung a serious leak. For, when she has a bit too much to drink at Mamie's Saloon, she's been known to tell tantalizing tales the Mounties would eagerly gobble up as evidence that can be used to clean up a city.

What fate awaits her? Who would line up to permanently silence her loose lyrics? What do these resonant rhymes reveal, and how far is Kelly willing to go to expose "The Boss's" influence on Moose Jaw's public officials? Are cryptic clues woven into her vitriolic verses? All will soon be neatly resolved - and revealed.

**Invitation for guests who DO NOT have roles.  
Run this page off back to back with the previous page.**

My limericks tell all with a rhyme.  
Now, listen and don't rush the time.  
Make sense of each word,  
Think about what you've heard.  
You'll find you can solve any crime.

МТК

27 Sept 28

She followed her nose and found money.  
Those that she met were not funny.  
They told her to go.  
She couldn't say "no!"  
Her future was dark and not sunny.

МТК

5 Oct 28

There once was a lass known as Kelly.  
She cleaned house and filled up his belly.  
She heard way too much,  
And knew such and such.  
Her life then was not worth a penny.

МТК

28 Sept 28

Soon, those in charge will be gone,  
Yet, the city will go on and on.  
They won't walk, they will mount,  
Those with badges won't count.  
They'll clean up the pros and the cons.

МТК

17 Oct 28

# Moose Jaw Times Herald

All the news that fits, we print!

October 24, 1928

## Crime rampant in "Little Chicago"

**City's top cop and mayor turn blind eye to corruption, gambling, payoffs**

By Rebecca Blackwell

Moose Jaw continues to live up to its "Little Chicago" reputation as new statistics released yesterday by the Royal Canadian government show a dramatic increase in all criminal activity in the city.

Despite this newspaper's ongoing efforts to interview new Mayor William F. Dunhill and Chief of Police Walter Wilson, both refuse to comment on their inability to control the growing crime wave that is crippling the ability of honest citizens to enjoy a good quality of life.

One outspoken citizen, Mabel Jensen, owner of The Moose Jaw Haberdashery, believes that the police know what's going on, but won't do anything about it. "My shop was burglarized a few weeks ago and who ends up with a new hat? Why, it was the wife of a police sergeant," she said, "You figure it out."

River Street is known as one of the roughest streets in all of Canada. Murders and bordellos are the norm and police seem to be doing nothing about them. The Canadian National Railroad station is a short walk away and makes it easy for lawbreakers to get in and out of Moose Jaw.

A businesswoman who isn't worried about crime is Suzette LaBelle, whose house is located on River



Main Street in Moose Jaw

Street. When asked to give her opinion, she reported, "Business is good. Business is always good. Why wouldn't it be good? Anyone who is worried about business not being

good must have the wrong kind of insurance."

Doctor Hugh Olds's office is in the heart of the River Street area. He

**Continued on back page.**

## Is "Scarface" the man in charge?

According to confidential sources, the man pulling the strings in Moose Jaw's criminal community is none other than "Scarface" Al Capone himself.

While no one is willing to admit they've actually seen him in Moose Jaw, the notorious Chicago gangster is rumored to maintain offices next to Mamie's Saloon on Main Street.

As with many commercial buildings in the city, the saloon connects to the underground tunnels constructed during the last century to house heating ducts and pipes. More entrances and tunnels are continually discovered when businesses remodel

or attempt to fix problems. The tunnels are reportedly perfect for hiding contraband and illegal operations.

Most city citizens have never seen the tunnels. Many of them are home to the large Chinese population of Moose Jaw that immigrated here to build the railroads.

One source who refused to be named stated that the Chinese and Capone have staked out their turf and occupy different tunnels.



Al Capone



From the desk of  
**RICHARD HART**

**CONFIDENTIAL**

Windows blackened  
by thick drapes

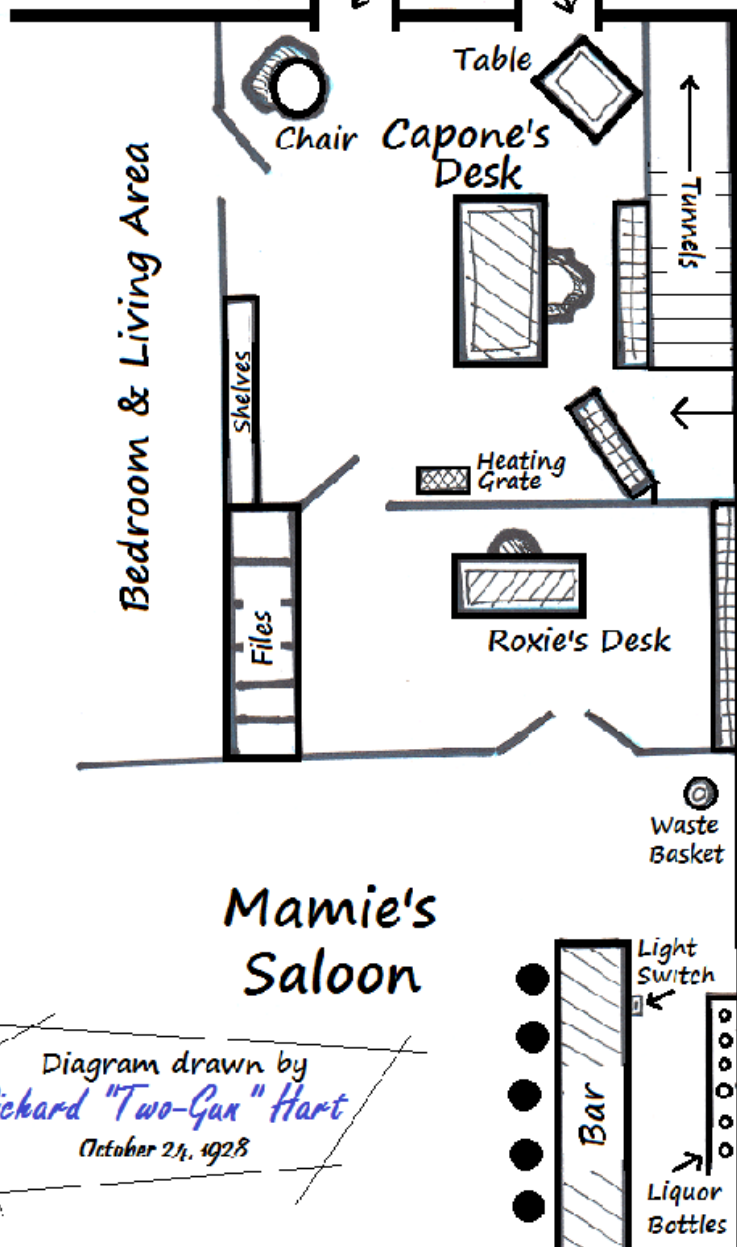

**Mamie's  
Saloon**

Diagram drawn by  
*Richard "Two-Gun" Hart*  
October 24, 1928